



A space
with a view

essentia

Guy's and St Thomas' **NHS**
NHS Foundation Trust

Events at Guy's and St Thomas'

A space
with a view

Whether your event requires decadence or functionality, our dedicated staff bring decades of hospitality experience and can help you plan your event to ensure it runs smoothly on the day.

We provide a full range of services from rooms and spaces with stunning views over central London to inspiring catering, flowers, decorations, audio-visual and marquee rental.

Giving back

Our profits are reinvested in Guy's and St Thomas' NHS Foundation Trust.

Contact

020 7188 6522
hospitalitybookings@gstt.nhs.uk

Education Centre
75–79 York Rd
London SE1 7NJ

Venue locations

1 St Thomas' Hospital
Westminster Bridge Road
London SE1 7EH

2 Florence Nightingale Museum
2 Lambeth Palace Road
London SE1 7EW

3 Education Centre
75–79 York Rd
London SE1 7NJ

4 Burrell Street Auditorium
4–6 Burrell Street
London SE1 0UN

5 Guy's Hospital
Great Maze Pond
London SE1 9RT



Exceptional hospitality in London

Events at Guy's and St Thomas'

A space with a view

Take advantage of 32 beautiful indoor and outdoor venues across London's most iconic hospital sites.

Guy's and St Thomas' NHS Foundation Trust is home to two of London's best known teaching hospitals, which embody a rich history of innovation, clinical excellence and service to the local community. Our historic sites are situated in the heart of London with easy access and transport links for you and your guests.

Our in-house hospitality team has many years' experience in helping organisations to deliver exciting and successful events. We take pride in providing the same flair to every event we manage, from small breakfasts and board meetings to large receptions and gala dinners. We have a firm commitment to getting it right every time and all our profits are reinvested into Guy's and St Thomas'.

To discuss your requirements, please get in touch with one of the team on hospitalitybookings@gstt.nhs.uk



St Thomas' Hospital

St Thomas' Hospital was named after Thomas Becket, the Archbishop of Canterbury who was assassinated in 1170. Run by a mixed order of Augustinian monks and nuns, the hospital originally provided shelter and treatment for the poor, sick and homeless. In 1539, during the Reformation, the monastery and hospital were dissolved, and then reopened 12 years later. The hospital moved to Lambeth in the 1860s with Queen Victoria laying the foundation stone at its current site in 1868. St Thomas' has been treating patients here ever since.

Guy's Hospital

In 1721, Thomas Guy applied to build a new hospital for the 'incurably ill and hopelessly insane'. The original hospital consisted of a courtyard facing St Thomas Street and an inner quadrangle. The buildings have been added to over the years and were extensively repaired following severe bomb damage during the Blitz. The 18th century chapel remains intact and includes the tomb of Thomas Guy. Today, the Guy's Hospital campus consists of 19 distinct buildings dating from the 18th century to the present day.

Room capacities

St Thomas', Guy's and off-site

A space
with a view

St Thomas' venues

Governors' Hall

Standing 250
Theatre 200
Formal dinner 110
Dinner Dance 90
Cabaret 120
Boardroom 40
Classroom 40
U-shape 40

Grand Committee Room

Standing 50
Formal dinner 24
Boardroom 24

South Wing Committee Room

Standing 35
Theatre 30
Cabaret 16
Boardroom 22
Classroom 12
U-shape 16

South Wing Lecture Theatre

Theatre 60

Shepherd Hall

Standing 250
Theatre 200
Formal dinner 200
Dinner Dance 160
Cabaret 120
Boardroom 40
Classroom 40

Central Hall

Standing 100

Senior Staff Room

Standing 40
Theatre 25
Formal dinner 20
Boardroom 26
U-shape 24

Florence Nightingale Museum

Standing 200
Theatre 25
Boardroom 15

Guy's venues

Robens Suite

Standing 180
Theatre 110
Formal dinner 110
Dinner Dance 75
Cabaret 100
Boardroom 40
Classroom 40
U-shape 40

Robens One

Theatre 15
Formal dinner 20
Cabaret 12
Boardroom 15
U-shape 15

ICAP MediCinema

Theatre 70

Atrium 1

Standing 400

Off-site venues

Burrell Street Auditorium

Theatre 85
Standing 150

Burfoot Court

Standing 40
Theatre 38
Cabaret 38
Boardroom 25
U-shape 20

Emily MacManus House

Standing 12/20
Theatre 30
Formal dinner 12/20
Boardroom 12/20
Classroom 20

Thomas Guy Suite

Standing 10/30
Theatre 30
Formal dinner 10/20
Boardroom 10/20
Classroom 20

Education Centre

Theatre 10/30
Boardroom 10/30
Classroom 10/30

Wi-fi access is included in the hire of all our venues.

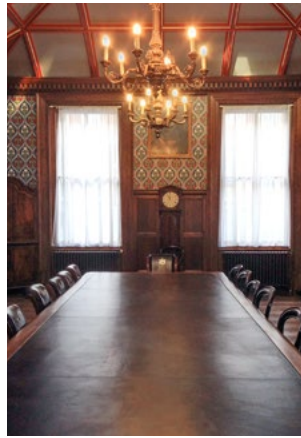

Clockwise from top left:
Governors' Hall
Grand Committee Room
Central Hall
South Wing Committee Room

Grand Committee Room, South Wing Committee Room, Governors' Hall and Central Hall

St Thomas'

Grand Committee Room

Adjacent to Governors' Hall is the Grand Committee Room, a flexible space with similar characteristics. The Grand Committee Room can be used with or without Governors' Hall.

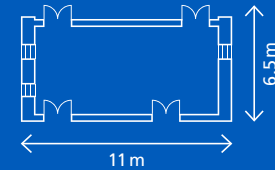

South Wing Committee Room

This intimate space works well for meetings, focus groups or as a break-out area from Governors' Hall.

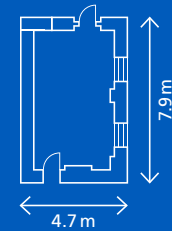

Governors' Hall

This Grade II listed room, set in the style of The Livery Hall at Guildhall London, showcases the grandeur of the 19th century and provides a spectacular backdrop for receptions and conferences.

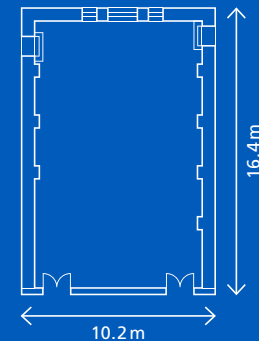

Central Hall

Retaining the character of the original building, this flexible area lends itself well to a pre-event space when used in conjunction with Governors' Hall or the Grand Committee Room.

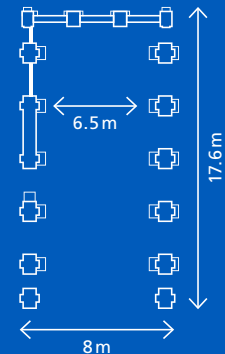

Senior Staff Room, South Wing Lecture Theatre and Shepherd Hall



Senior Staff Room

Take a step back in time with one of the hospital's oldest rooms, built over 100 years ago and still retaining many of its original features. This unique room is the perfect place for an intimate dinner or celebration.

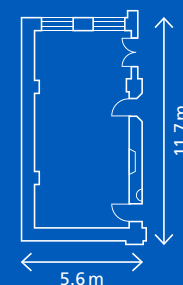

South Wing Lecture Theatre

The South Wing Lecture Theatre offers tiered seating with state-of-the-art audio visual, including video conferencing facilities. Available for use on its own or in conjunction with other nearby spaces.

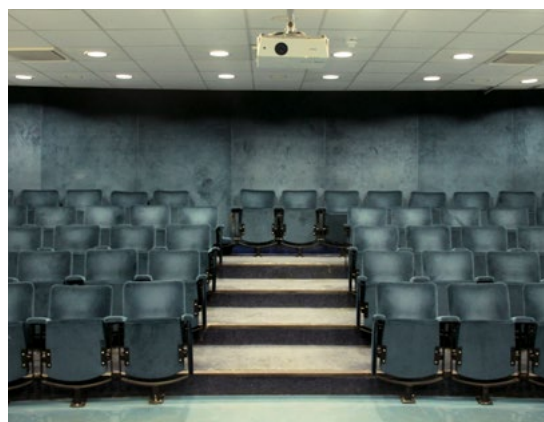
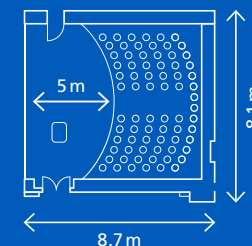

Shepherd Hall

Situated in the original part of St Thomas', Shepherd Hall can be used for drinks receptions and parties all year round. This large contemporary interior space contrasts beautifully with the 19th century architecture of the hospital. With access to a terrace overlooking the River Thames and Houses of Parliament, the spectacular views are sure to impress.

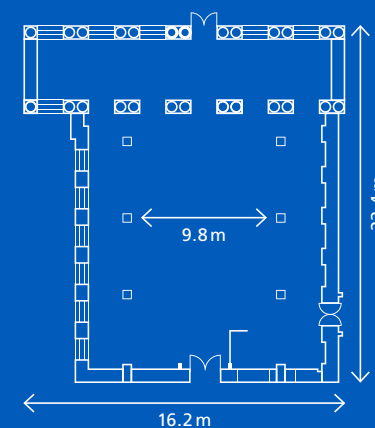

Clockwise from top:
Shepherd Hall
South Wing Lecture Theatre
Senior Staff Room



From top:
Parliament Panorama
Florence Nightingale Museum

Florence Nightingale Museum and Parliament Panorama

St Thomas'

Florence Nightingale Museum

Entertain and spoil your guests at a reception or drinks party in the Florence Nightingale Museum. Guests can learn about the founder of modern day nursing, who set up the first official nurses' training programme at St Thomas', by exploring the exhibitions during the course of your event.

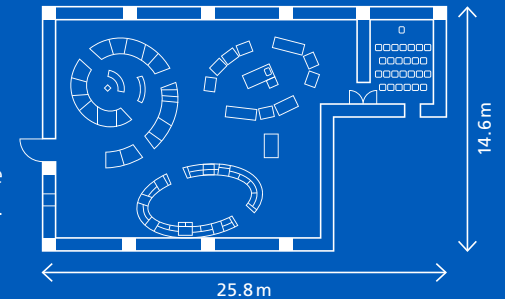

Parliament Panorama

The green and leafy outdoor space of Parliament Panorama enjoys spectacular views towards the Houses of Parliament, Big Ben and Westminster Bridge. Situated on the south bank of the River Thames, this space offers guests many possibilities for parties, celebrations and corporate events.

Parliament Panorama can accommodate large scale marquees and stages for special events.

Robens Suite, Robens One, ICAP MediCinema and Atrium 1

Guy's



Clockwise from top left:
Robens Suite
Robens One
Atrium 1
ICAP MediCinema

Robens Suite

Located at the top of Guy's Tower, a London landmark and the tallest hospital building in the world, Robens Suite offers spectacular views and a flexible meeting or entertainment space.

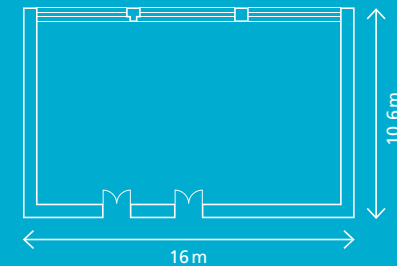

Robens One

Adjacent to Robens Suite and benefiting from similar sweeping views, Robens One is the perfect space for break-out events or more intimate dinners. It can be used with or without Robens Suite.

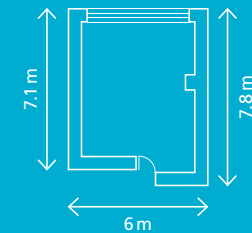

ICAP MediCinema

Our state-of-the-art cinema offers an immersive cinema-going experience. Guests will be treated to the highest picture quality, 3D capability, the very latest in digital projection and luxurious seating.

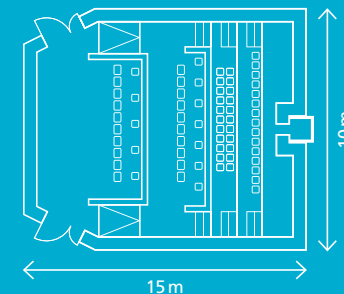

Guy's Atrium 1

This stunning public atrium provides over 600 m² of flexible floor space and is used for exhibitions, fairs and receptions. It can also be used in conjunction with other spaces, such as ICAP MediCinema.

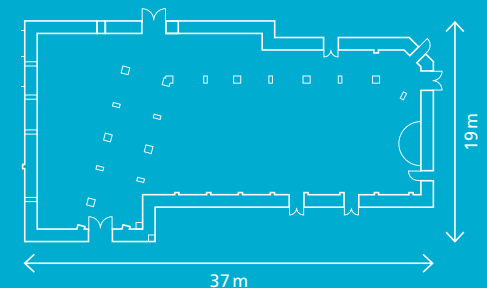



From top:
Emily MacManus House
Burfoot Court

Burfoot Court, Thomas Guy Suite and Emily MacManus House

Guy's

Burfoot Court

Burfoot Court is a stunning grade II listed space with state-of-the-art facilities against a traditional backdrop. This is an ideal place for a conference, workshop or presentation with a difference.

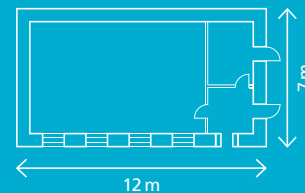

Thomas Guy Suite

This suite provides an adaptable and functional space with a side room for breakout or catering.

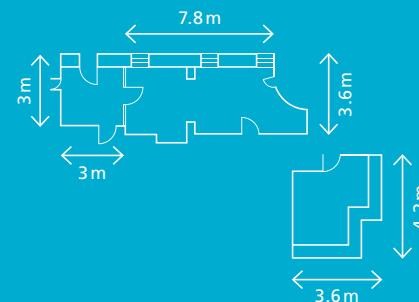

Emily MacManus House

This classic venue, based in the original Guy's Hospital building, has a rich history having survived the bombings of World War II.

Choose between the period dining room downstairs and the larger lounge area upstairs.

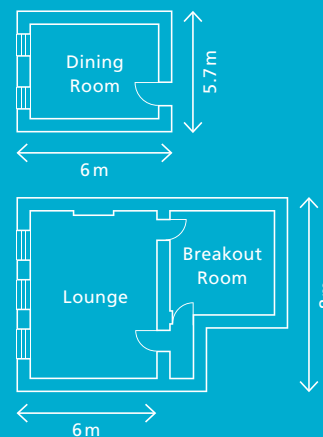

Due to the age of the building, there is no step-free access to Emily MacManus House.



Burrell Street Auditorium and Education Centre

Off-site

Burrell Street Auditorium

A modern space set within converted railway arches, Burrell Street Auditorium is ideal for training sessions, team building activities or presentations. The auditorium is fully equipped with AV facilities including ceiling microphones for excellent acoustics, video conferencing equipment and three large screens, including a smart board.

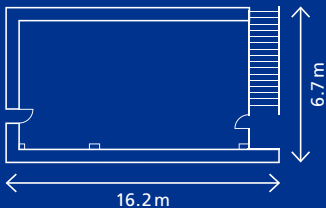

Education Centre

With 20 different rooms to choose from and numerous layout options available, our light and airy meeting rooms and seminar rooms can meet all your business needs.

Need an alternative venue?

Through our network of community facilities we can offer a diverse range of flexible venue spaces across London. Tell us about your event and ideal location and let us help you find the perfect space.

Clockwise from top:
Burrell Street Auditorium entrance
Burrell Street Auditorium interior
Education Centre interior



Introduction to catering and our menus

Catering

A passion for food and drink

We have a multi-talented team of chefs with a vast amount of experience between them. The team bring different styles, techniques and influences to the kitchen while following our philosophy of seasonal, sustainably-sourced and flavoursome food.

Our menus are based around food that is freshly prepared on-site and we actively source local ingredients, where possible. We champion local food producers and recognise the importance of supporting our community.

We offer a choice of menus for any occasion. Our chefs are also happy to work with you to create bespoke menus for any special events or diets.

Already have a venue?

From breakfast meetings or working lunches to retirement parties and corporate events, our highly-skilled chefs create exciting and seasonal menus to meet your catering requirements.

We can also provide waiting staff and all the hire equipment that you may need to make your event run as smoothly as possible.

Sample full day delegate menu

From £37.50 pp

On arrival

- Freshly ground coffee and speciality teas
- Orange juice
- Mini Danish pastries and croissants

Mid-morning and mid-afternoon

- Freshly ground coffee and speciality teas
- Mineral water
- Biscuits or healthy snacks

Lunch (choice of)

- Selection of bridge rolls (V)
- Assorted mini quiches (V)
- Char-grilled vegetable skewers with goats cheese and honey glaze (V)
- Smoked fish selection with rocket and watercress and horseradish cream
- Carved ham hock terrine with piccalilli
- Roasted Mediterranean vegetable terrine with sundried tomato sauce (V)
- Ploughman's platter including ham, cheese, breads and pickle
- Broccoli and stilton tart (V)
- Salmon and asparagus terrine with hollandaise mayonnaise
- Root vegetable strudel with tomato salsa (V)
- Classic Caesar salad

(V=Vegetarian)



Tasting dishes and dinner menu

Catering

Sample tasting dishes

From £7.50 pp

- Cumberland sausages with mashed potato and onion gravy
- Thai green curry with jasmine rice
- Chickpea curry with naan bread (V)
- Singapore noodles with spring rolls (V)
- Fisherman's pie
- Mushroom stroganoff (V)
- Pesto salmon with crusted new potatoes
- Lamb hotpot
- Vegetable casserole in a rich tomato sauce with herb dumplings (V)(Ve)
- Slow cooked beef in rich ale gravy

Wines

Our wine list has a wide range of interesting wines with varied origin, flavour and aroma. We can suggest the perfect wine to suit any occasion and budget.

Sample three course dinner menu

From £35 pp

Starters

- Summer bean salad served with feta and pomegranate (V)
- Black peppered mackerel on a bed of apple and celery salad
- Chicken liver pâté with watercress salad and toasted sourdough
- Pea and mint soup (V)

Mains

- Roasted monkfish flavoured with garlic and fennel
- Beef Wellington served with new potatoes and wilted spinach
- Roast tomato and pepper strudel with new potatoes and wilted spinach (V)
- Lamb chops with a pesto crumb served with Jersey Royals

Desserts

- Poached peaches with strawberry compote and vanilla cream (V)
- Strawberry meringues with fresh and dried strawberries (V)
- Chocolate and caramel profiteroles (V)

To finish

- Freshly ground coffee or tea selection with petit fours

(V=Vegetarian Ve=Vegan)



Event management, accommodation, Audio Visual (AV) and extras

Additional

Event management

Let us take the stress out of planning your event. We work with you to understand your aim and then provide a creative and bespoke event solution.

We're committed to exceeding your expectations so you can relax knowing that your event will be successful. From concept to delivery, we believe in providing the best possible experience for you and your guests.

Our team can manage every aspect of your event, or just those aspects you want us to. Whatever we do, we do meticulously, with expertise and enthusiasm.

Examples of recent events

- Multi-day conferences
- Weddings
- Reunion dinners
- Festivals
- Workshops
- Away days

Accommodation

Accommodation is available on both the Guy's and St Thomas' sites, offering guests comfortable and stylish rooms. Set within the heart of the city, both accommodation sites have a central location for those wishing to explore the city of London and beyond.

Audio Visual (AV)

From small meetings to large conferences, we have the latest AV technology for all types of events. We own an extensive range of equipment and are constantly investing in new technology. Whatever your budget, we can provide a solution to suit your requirements.

Equipment hire

- Portable PA system
- Push to talk conference microphones
- Laptops
- Portable speakers for laptops
- Projector and screen
- LED screens

We can also supply a dedicated AV Technician for your event, who will ensure the smooth running of all logistics is taken care of from start to finish.

Extras

We offer beautiful venues, first-class catering, state-of-the-art AV, and an experienced team. We are also on hand to provide additional support as needed. Whether it's entertainment, flowers, transport, prop hire or anything else – our team will always endeavour to make your event the best it can be.