

# South Wing - First Floor

Access only via these lifts:

## Lift B only

- Children's Services
  - Neurosciences
  - Outpatients
  - Rare Diseases Centre
- Services
  - Chapel
  - Information Governance
  - Spiritual Care

## Lift C only

- Children's Services
  - Cleft Services
  - Outpatients
  - Medical Photography
  - Mycology

## Lift D only

- Children's Services
  - Sleep and Respiratory Centre
  - Snow Fox



We're smoke-free No photos

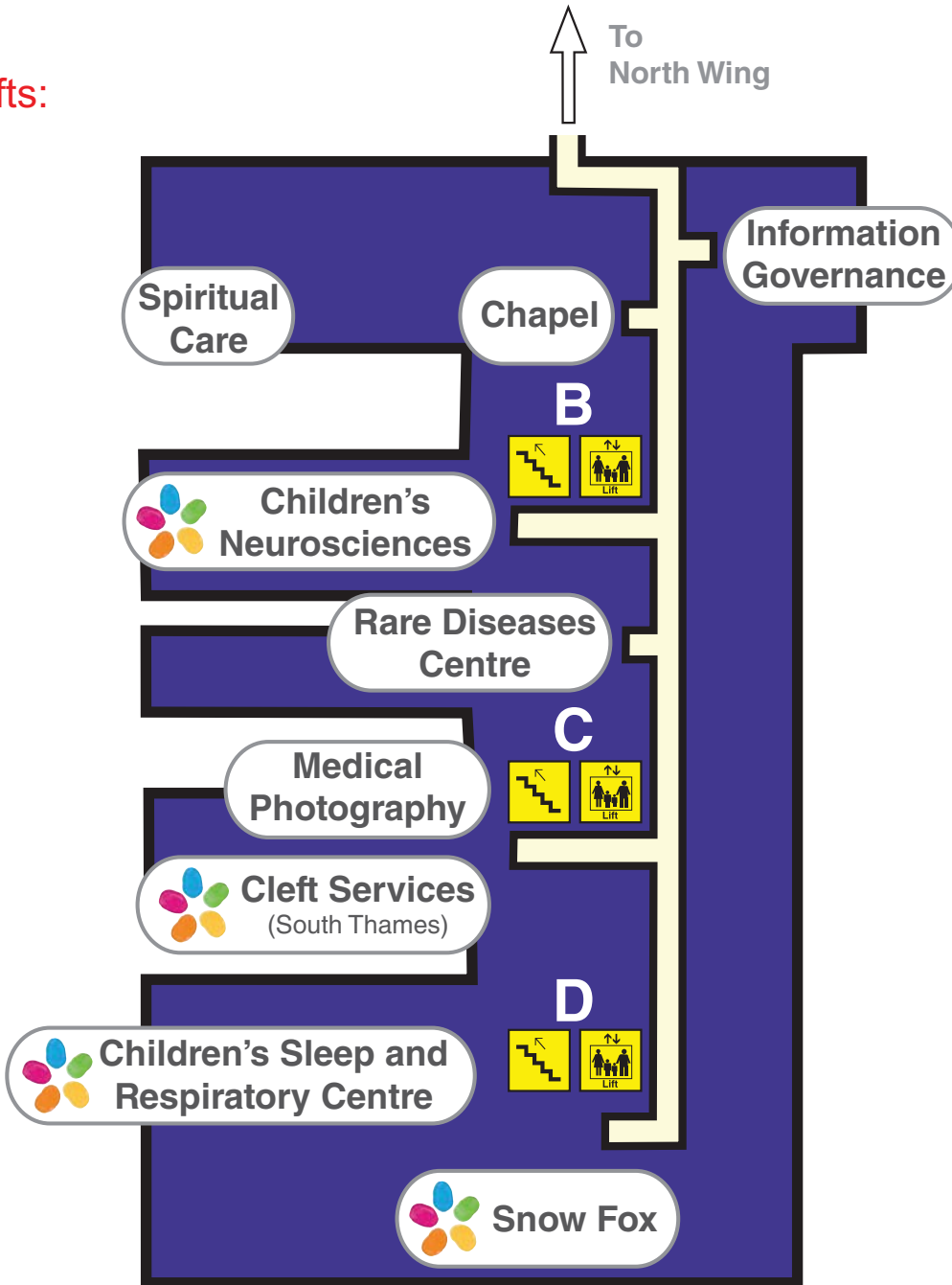

## Ground Floor Plan

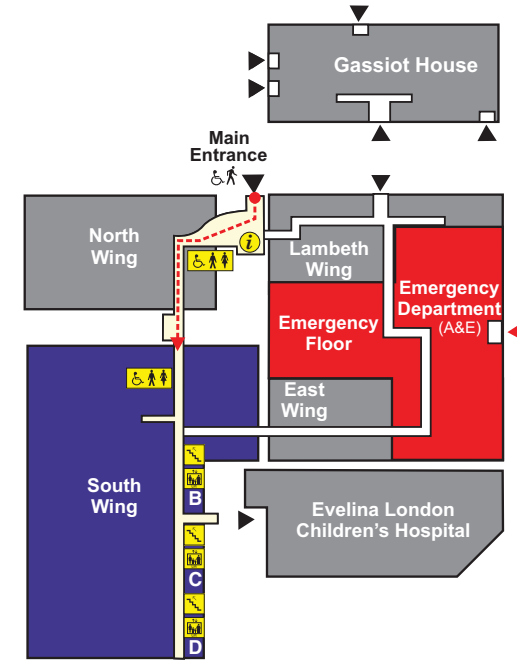

## Key

- Building Entrances
- Route to Wing
- Pedestrian Access
- Disabled Access
- Main Corridors
- Information
- Lifts - B, C, D
- Stairs
- Toilets
- Directions to Wings